

Coronavirus Panel - Nasopharyngeal Specimen Collection Instructions



****Note: Transport tubes must be stored in refrigerator at all times**
Do NOT ship samples on Saturday. Please refrigerate samples, and ship on Monday.**

Materials:

Sterile Nasopharyngeal swab

Viral transport media tube (should contain 1-3 mL of sterile viral transport medium)

Specimen Collection Instructions

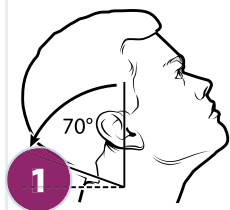

Tilt patient's head back 70 degrees.

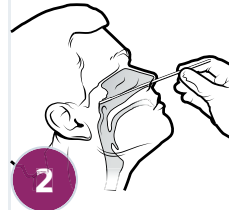

Insert swab into nostril. (Swab should reach depth equal to distance from nostrils to outer opening of the ear.) Leave swab in place for several seconds to absorb secretions.

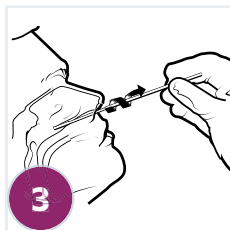

Slowly remove swab while rotating it. (Swab both nostrils with same swab.)

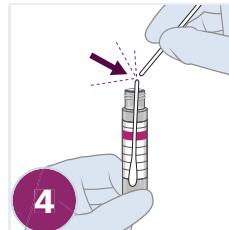

Place tip of swab into sterile viral transport media tube, and snap/cut off the applicator stick.

Specimens must be packaged, shipped, and transported as directed by Advanta according to the current edition of the International Air Transport Association (IATA) Dangerous Goods.

Shipping Checklist:

- Collected sample in transit tube
- Sample tube labeled with first and last name, and DOB
- Completed requisition with demographics and insurance info
- Shipped in cooler with ice pack

THE HUMAN ADVANTAGE
IN LABORATORY TESTING

Advanta Analytical Laboratories
10935 CR 159 • Tyler, TX 75703

Phone: 903.805.9955
Fax: 903.839.2494

CLIA #: 45D2063134
www.aalabs.com

Coronavirus Panel - Oropharyngeal Specimen Collection Instructions



****Note: Transport tubes must be stored in refrigerator until used****
Do NOT ship samples on Saturday. Please refrigerate samples, and ship on Monday.

Specimen Collection Instructions



Open the collection swab wrapper by peeling open the top of the wrapper. Remove the swab, **taking care not to touch the tip** of the swab or lay it down.

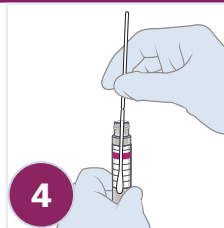

While holding the swab in the same hand, aseptically remove the cap from the tube. **Insert the swab into the tube** with the transport medium.

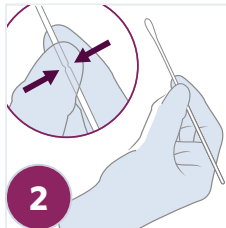

Hold the swab in your hand, placing your thumb and forefinger in the middle of the swab shaft across the scoreline.

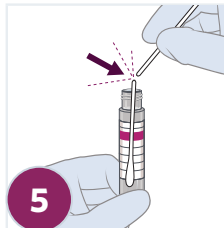

Identifying the scoreline, break the swab shaft against the side of the tube. If needed, gently rotate the swab shaft to complete the breakage. **Discard the top portion** of the swab shaft.

Avoid splashing contents on the skin. Wash with soap and water if exposed.

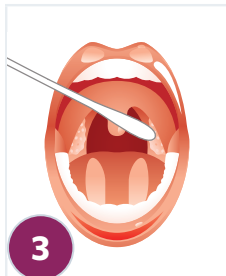

Vigorously swab tonsillar area and posterior oropharynx using the swab. Rotate the swab several times.

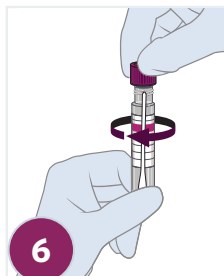

Replace the cap onto the tube & close tightly to prevent leaks. All specimens should be sent immediately after collection. If the specimen cannot be sent immediately, **refrigerate** until shipped (do **not** freeze). Specimens should be transported to Advanta according to standard operating procedures. Use Coldpacks/coolers.

Specimens must be packaged, shipped, and transported as directed by Advanta according to the current edition of the International Air Transport Association (IATA) Dangerous Goods.

Shipping Checklist:

- Collected sample in transit tube
- Sample tube labeled with first and last name, and DOB
- Completed requisition with demographics and insurance info
- Shipped in cooler with ice pack

THE HUMAN ADVANTAGE
IN LABORATORY TESTING

Advanta Analytical Laboratories
10935 CR 159 • Tyler, TX 75703

Phone: 903.805.9955
Fax: 903.839.2494

CLIA #: 45D2063134
www.aalabs.com

COVID-19 Panel - Blood Serum

Specimen Collection Instructions



Please ship samples the day they are collected.
Do NOT ship samples on Saturday. Please refrigerate samples, and ship on Monday.

Specimen Collection Instructions

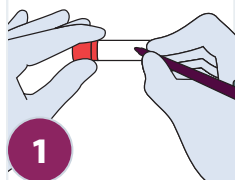

Clearly print **Patient Name** (first & last), **Date of Birth** & **Specimen Collection Date** on the SST.



Place the SST into the biohazard bag.

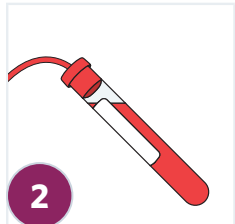

Draw the blood utilizing the SST provided. 1 fully drawn SST yields about 3-4 mL of serum. **Gently invert tube 4-5 times.** Serum tubes must be placed in an **upright, vertical position** and allowed to **clot for a minimum of 30 minutes** before centrifuging.

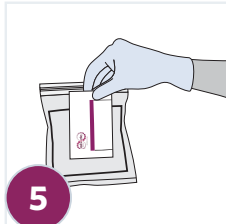

Put the completed requisition form in the **outside pocket** of the biohazard bag.

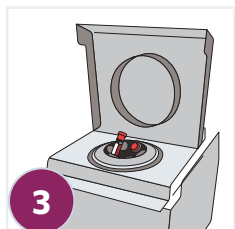

After specimen has been allowed to fully clot, the tube must be centrifuged within 1 hour of collection and no longer than 2 hours after collection. Centrifuge at **2500-3000 RPM for 15 minutes.** (optional for those without centrifuge)

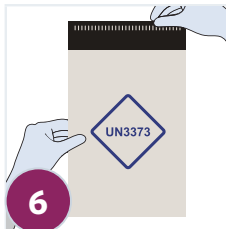

Insert biohazard bag with samples in mailing envelope Mail Tuff plastic with bubble wrap liner or cooler with ice pack labeled according to **UN3373** regulations for mailing Category B biological samples. Please use provided return shipping labels.

Specimens must be packaged, shipped, and transported as directed by Advanta according to the current edition of the International Air Transport Association (IATA) Dangerous Goods.

Stability Requirements

Temperature	Period
Room temperature	3 days
Refrigerated	7 days
Frozen	7 days
Freeze/thaw cycles	Stable x3

Shipping Checklist:

- Collected sample in SST tube
- Sample tube labeled with first & last name, DOB, & specimen collection date
- Completed requisition with demographics & insurance info
- Shipped in UN3373 bubble wrap lined mailing envelope or cooler with ice pack

THE HUMAN ADVANTAGE

IN LABORATORY TESTING

Advanta Analytical Laboratories
 10935 CR 159 • Tyler, TX 75703

Phone: 903.805.9955
 Fax: 903.839.2494

CLIA #: 45D2063134
www.aalabs.com