

# Coronavirus Panel - Oropharyngeal Specimen Collection Instructions

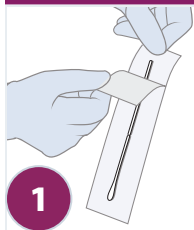

**\*\*Note: Transport tubes must be stored in refrigerator until used\*\***  
**Do NOT ship samples on Saturday. Please refrigerate samples, and ship on Monday.**

## Specimen Collection Instructions



Open the collection swab wrapper by peeling open the top of the wrapper. Remove the swab, **taking care not to touch the tip** of the swab or lay it down.

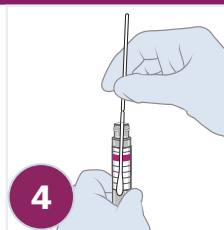

While holding the swab in the same hand, aseptically remove the cap from the tube. **Insert the swab into the tube** with the transport medium.

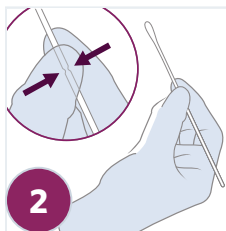

**Hold the swab in your hand**, placing your thumb and forefinger in the middle of the swab shaft across the scoreline.

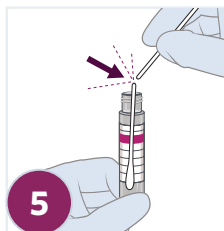

Identifying the scoreline, break the swab shaft against the side of the tube. If needed, gently rotate the swab shaft to complete the breakage. **Discard the top portion** of the swab shaft.

Avoid splashing contents on the skin. Wash with soap and water if exposed.

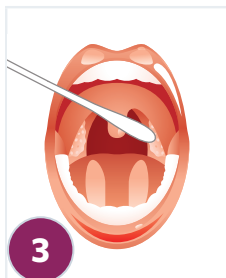

**Vigorously swab** tonsillar area and posterior oropharynx using the swab. Rotate the swab several times.

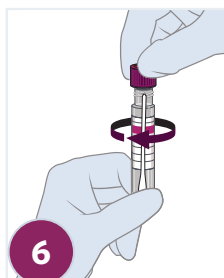

**Replace the cap** onto the tube & close tightly to prevent leaks. All specimens should be sent immediately after collection. If the specimen cannot be sent immediately, **refrigerate** until shipped (do **not** freeze). Specimens should be transported to Advanta according to standard operating procedures. Use Coldpacks/coolers.

**Specimens must be packaged, shipped, and transported as directed by Advanta according to the current edition of the International Air Transport Association (IATA) Dangerous Goods.**

### Shipping Checklist:

- Collected sample in transit tube
- Sample tube labeled with first and last name, and DOB
- Completed requisition with demographics and insurance info
- Shipped in cooler with ice pack

**THE HUMAN ADVANTAGE**  
IN LABORATORY TESTING

Advanta Analytical Laboratories  
10935 CR 159 • Tyler, TX 75703

Phone: 903.805.9955  
Fax: 903.839.2494

CLIA #: 45D2063134  
www.aalabs.com